



Seat Device Disassembly

Full power adjusted type:

NOTE:

- Before installing the seat, make sure there are no twists or pinch in the seat wires.
- Grease the moving surface.

Bolts torque:

- ① 20 N·m (2.0 kg-m, 14 lb-ft)
- ② 5 N·m (0.5 kg-m, 3.6 lb-ft)
- ③ 9 N·m (0.9 kg-m, 6.5 lb-ft)

NOTE: *On reassembly, use liquid thread lock.

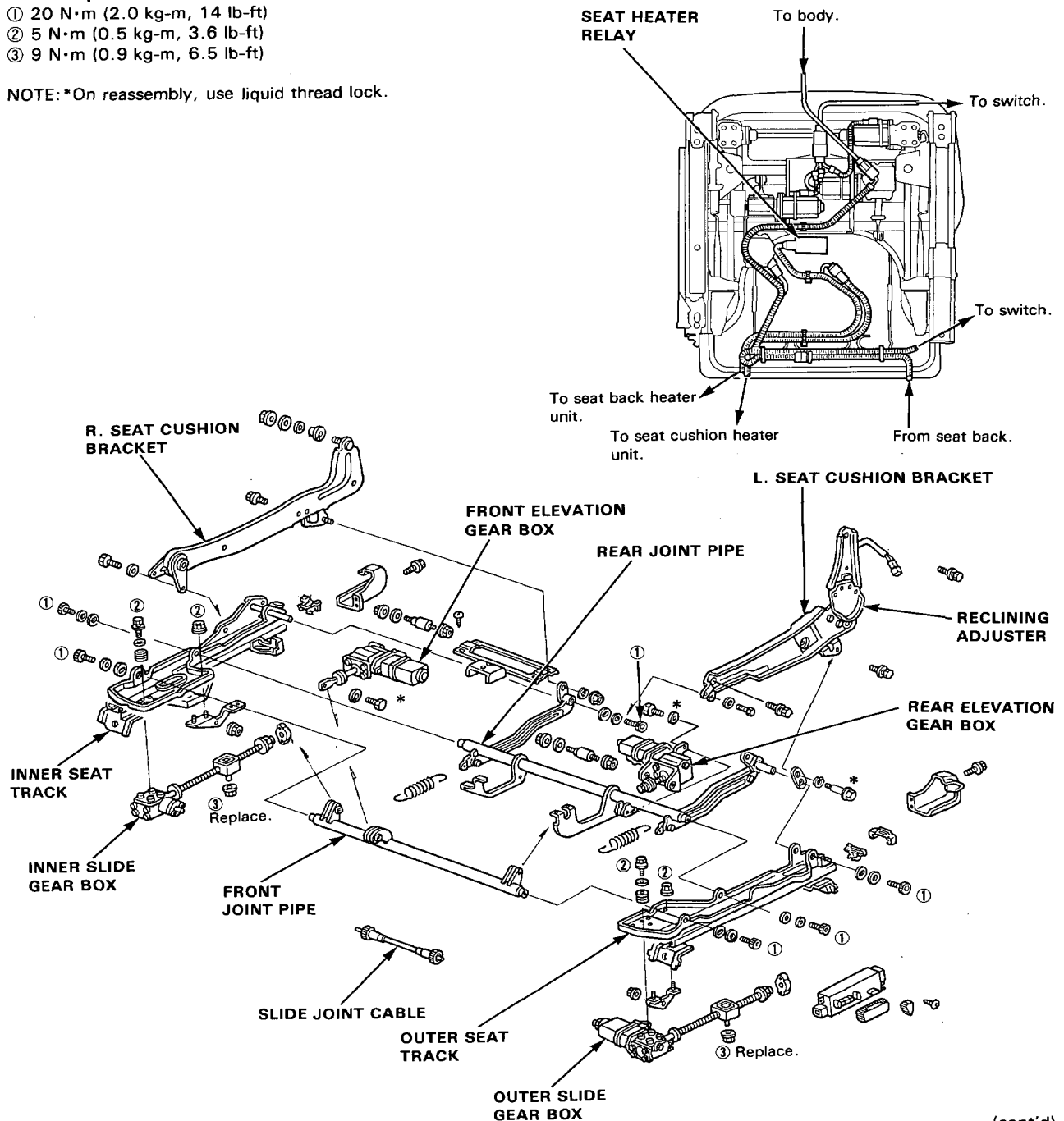

(cont'd)